



TM

# F R I E D R I C H

## Dehumidifier

### D35B1A, D50B1A

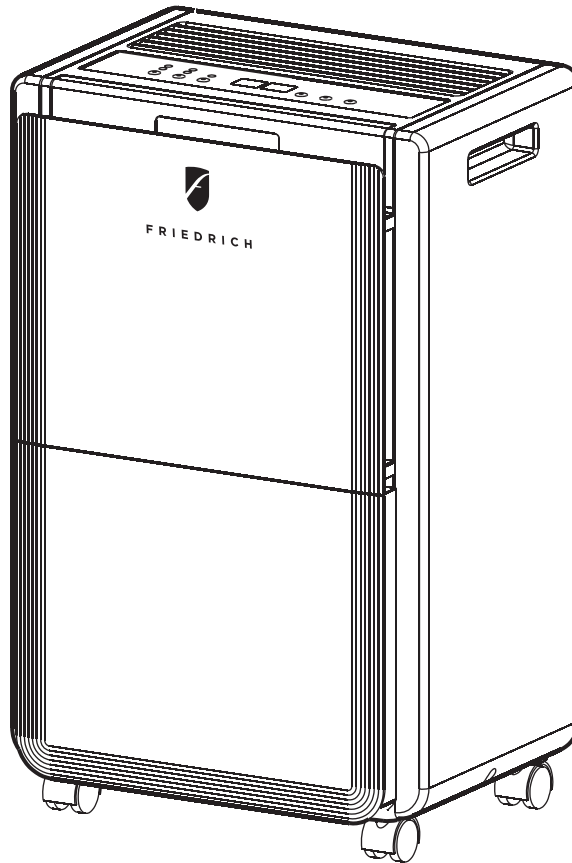

### Models

---

D35B1A	Volts: 115/60Hz	Capacity: 35 Pints	Moisture Removal: 35 Pint/Day
D50B1A	Volts: 115/60Hz	Capacity: 50 Pints	Moisture Removal: 50 Pint/Day

---

# Congratulations!

Thank you for your decision to purchase the Friedrich Dehumidifier. Please read thoroughly of this Installation and Operation Manual.

# THANK YOU, on behalf of our entire company, for making such a wise purchase.

## Table of Contents

DESCRIPTION OF COMPONENTS .....	3
FUNCTION EXPLANATION .....	3
INSTALLATION INSTRUCTIONS.....	4
OPERATION INSTRUCTIONS.....	4
OPERATING DO'S AND DON'TS .....	6
CONTINUOUS DRAINAGE.....	8
MAINTENANCE.....	10
IN CASE OF EMERGENCY.....	11
TECHNICAL SPECIFICATIONS.....	11

	<b>⚠ WARNING</b>	<b>⚠ AVERTISSEMENT</b>	<b>⚠ ADVERTENCIA</b>
<b>THINK SAFETY FIRST</b>	Do not remove, disable or bypass this unit's safety devices. Doing so may cause, fire, injuries or death.	Ne pas supprimer, désactiver ou contourner cette l'unité des dispositifs de sécurité. faire vous risqueriez de provoquer, le feu, les blessures ou la mort.	No eliminar, desactivar o pasar por alto los dispositivos de seguridad de la unidad. Si lo hace podría producirse fuego, lesiones o muerte.

61952220

# DESCRIPTION OF COMPONENTS

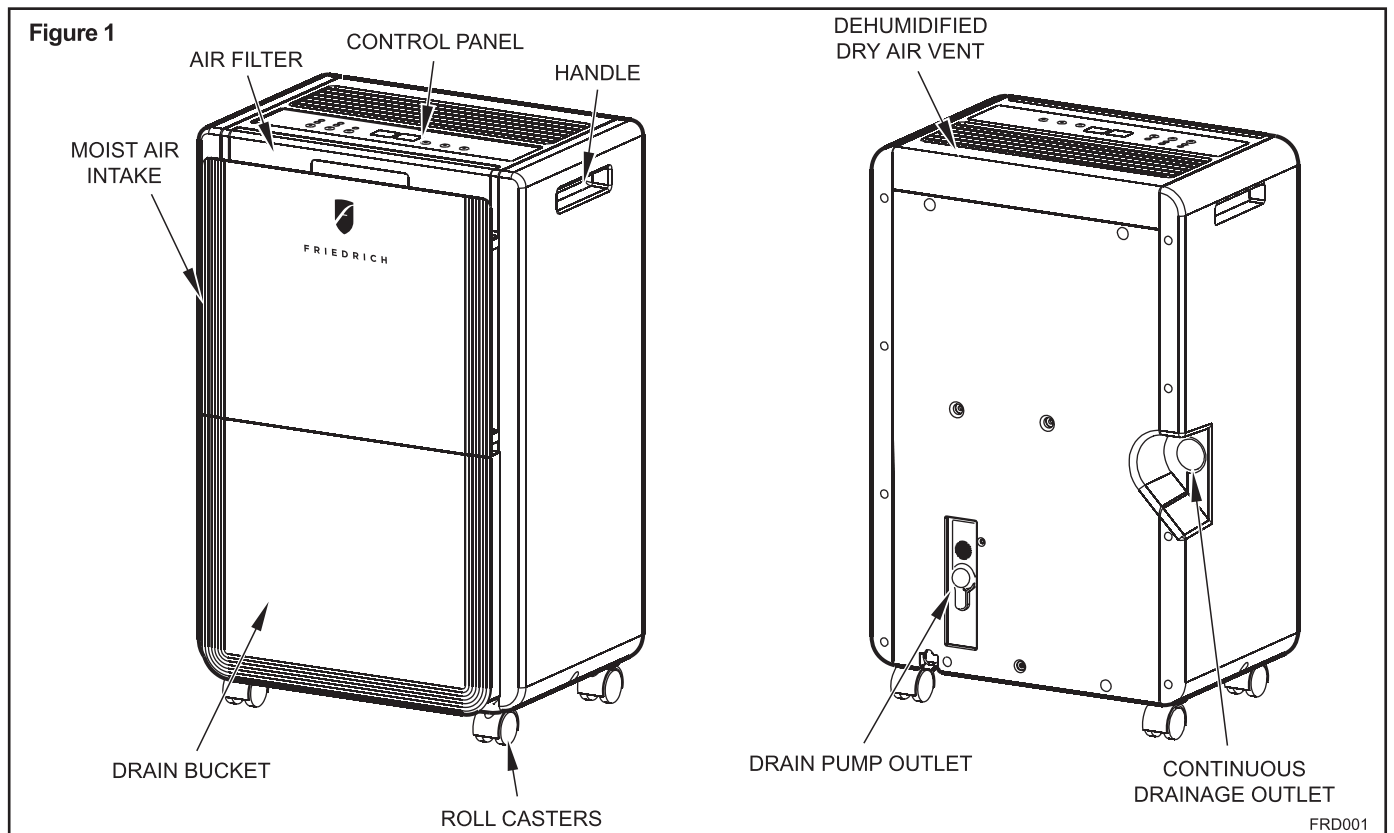

# FUNCTION EXPLANATION

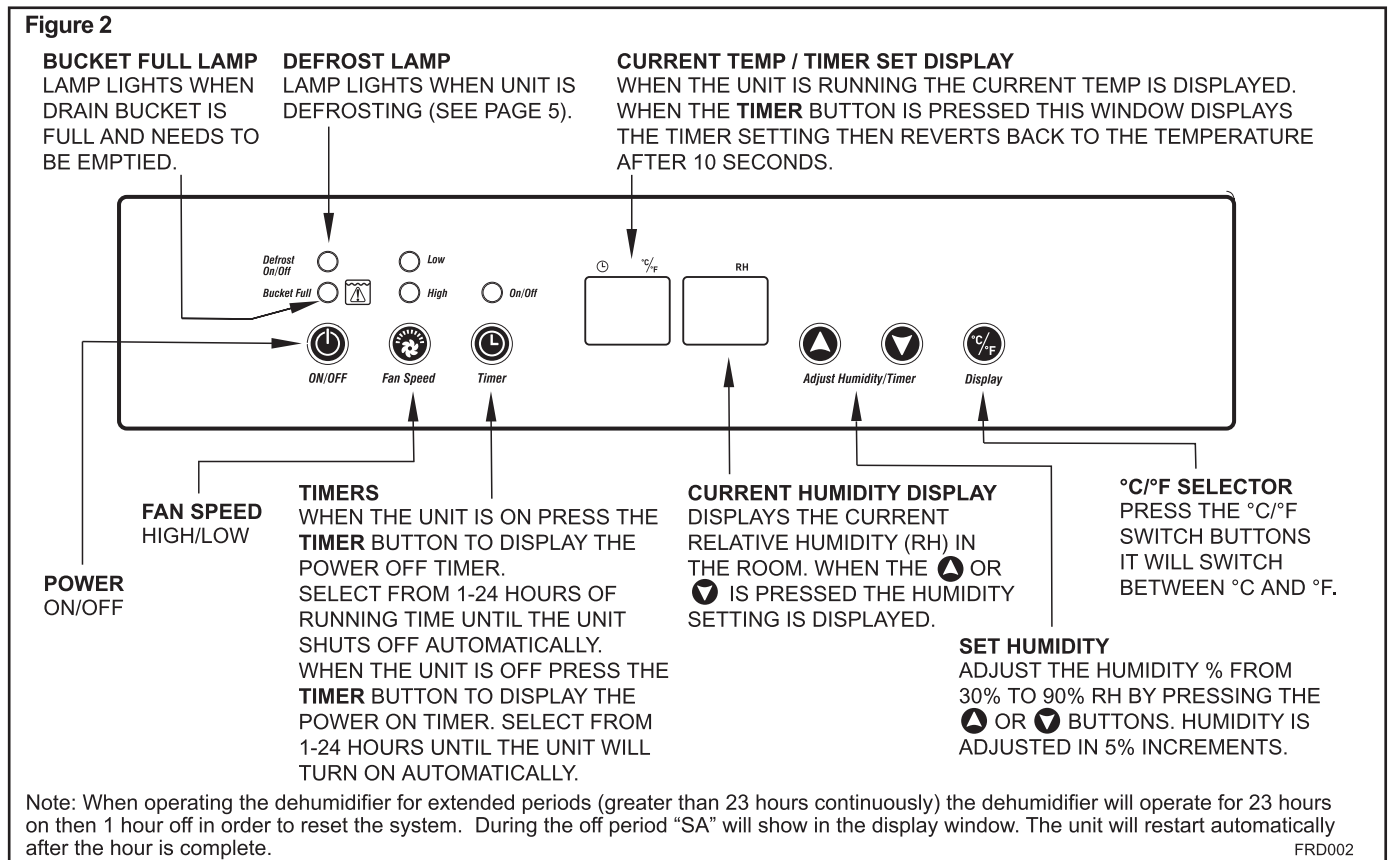

# INSTALLATION INSTRUCTIONS

Follow the steps below for unpacking and set up your unit.

- STEP 1.** Remove unit from carton and inspect.
- STEP 2.** Remove accessories from drain bucket.
- STEP 3.** Set up unit in position with adequate clearance. Installation of unit is complete.

Allow at least 8 inches of space all around the unit and at least 24 inches of space above the unit.

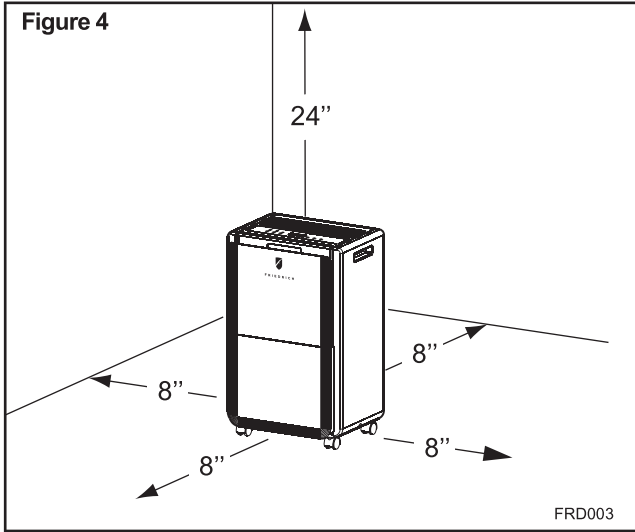

# OPERATION INSTRUCTIONS

## **WARNING**

### Electrical Hazards

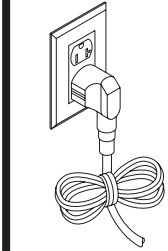

Do not fold power cord as shown at left.

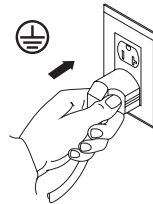

Make sure the plug is placed fully and firmly into the receptacle.

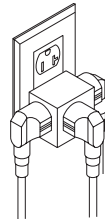

Do not use multiple sockets as shown at left.

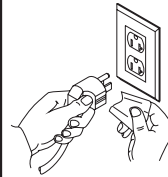

Make sure the plug is clean.

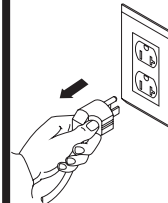

After turning the unit off please take plug out of the receptacle.



Do not have wet hands when connecting the power plug.

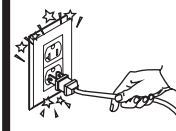

Do not pull the power cord to avoid a broken cord, which can lead to danger.

## Start Operation

**STEP 1.** Place the unit in an upright position on a flat, steady, stable and heat resistant surface. Make sure there is nothing flammable or heat sensitive within 39 inches. Operating the product in any other position could cause a hazard.

<b>⚠ WARNING</b>	
	<p><b>Electrical Shock Hazard</b></p> <p>Make sure your electrical receptacle has the same configuration as your dehumidifier's plug. If different, consult a Licensed Electrician.</p> <p>Do not use plug adapters. Do not use an extension cord. Do not remove ground prong.</p> <p>Always plug into a grounded 3 prong outlet. Failure to follow these instructions can result in death, fire, or electrical shock.</p>

**STEP 2.** Insert the plug into a suitable wall socket. The dehumidifier is suitable for operation on an electricity supply having the same voltage as that shown on its rating label.

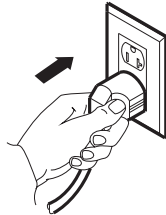

**STEP 3.** Make sure the **Drain Bucket** is correctly placed in the proper position (See Figure 5). (After switching the unit "ON" for the first time, if the **Bucket Full** lamp illuminates, just pull out the drain bucket; check to ensure that the **float** lever is able to move freely, then return the drain bucket to the correct position).

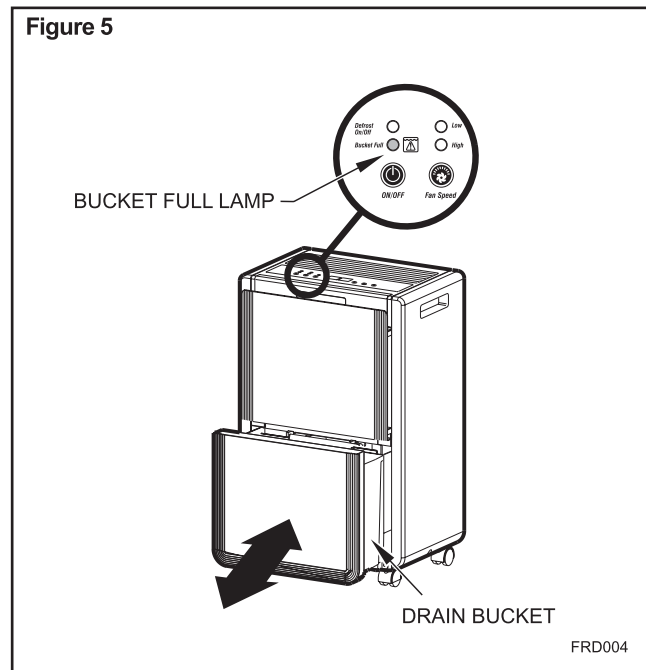

## When Bucket Full Lamp Is On

When the drain bucket is full, the **Bucket Full** lamp will illuminate and the unit will stop operating. The drain bucket should be carefully removed from the unit by sliding it outwards (See Figure 6) and should be emptied. Then place the empty drain bucket back to its proper position, (See Figure 7) the unit will start operating and run normally.

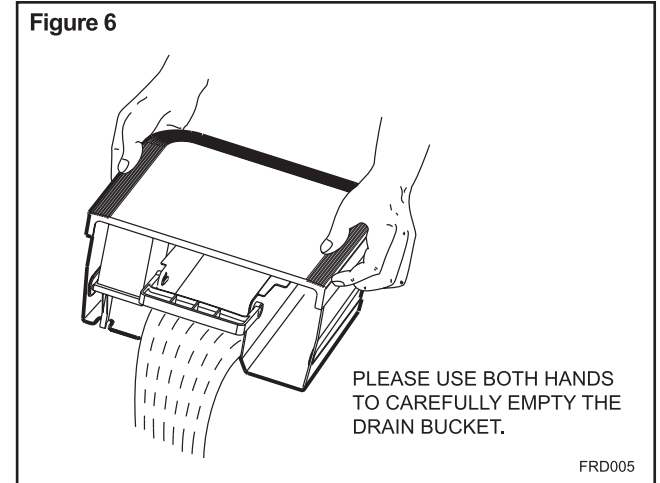

## Defrost

When the unit is operated in low temperatures (less than 54 °F) the surface of the evaporator will accumulate a layer of frost which will reduce the efficiency of the dehumidifier. When this happens the unit will go into periodic defrost mode automatically. The Defrost Lamp will illuminate on control panel, this is quite normal (See Figure 7).

The dehumidifier will operate in temperatures down to 41 °F. The time it takes to defrost may vary. If the unit freezes up it should be turned off at the power supply for a few hours and then re-started. If the room temperature remains below 41 °F the unit should be switched off. It is not recommended to use the dehumidifier in temperatures below 41 °F.

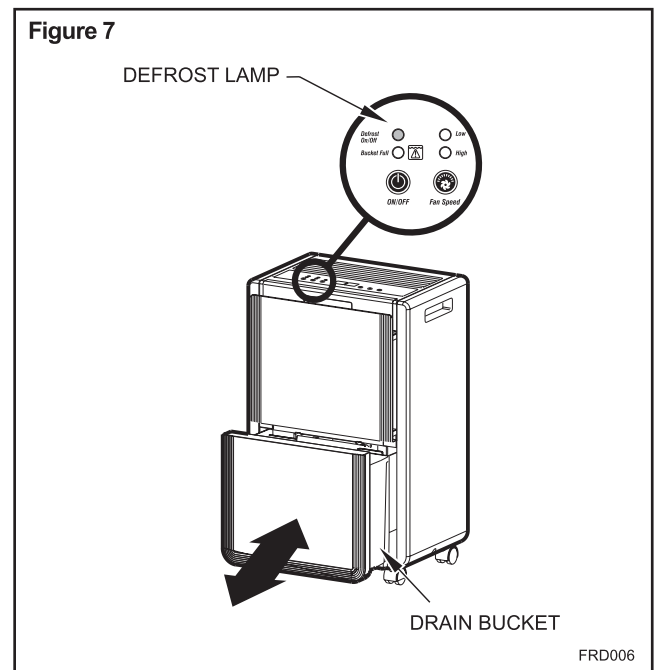

## OPERATING DO'S AND DON'TS

Do not place anything on top of the unit or control panel (See Figure 8).

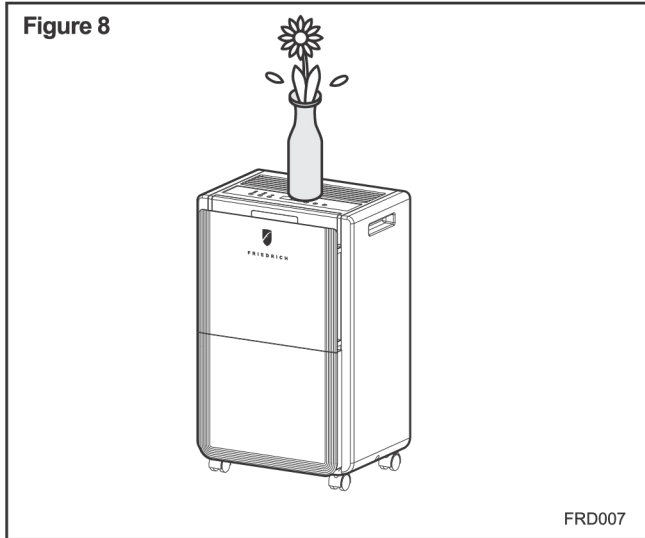

Do not place anything over the inlet or outlet points (See Figure 9).

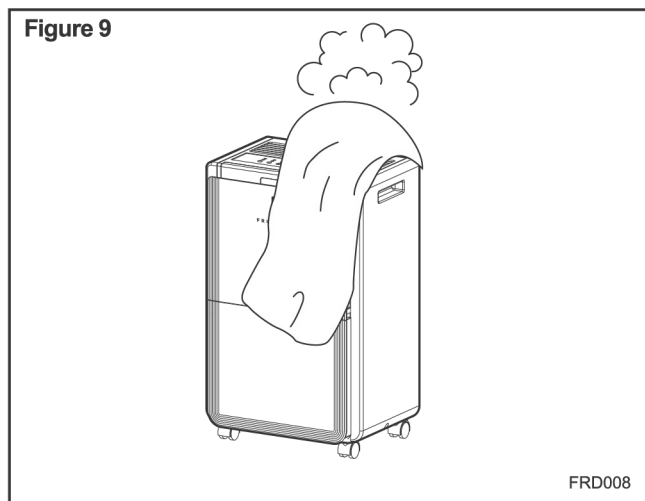

Do not wet the unit or the control panel (See Figure 10).

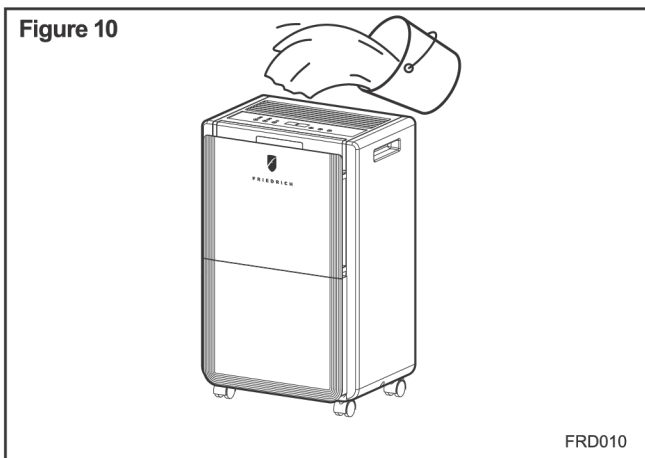

Do not use insect, oil or paint spray around the unit (See Figure 11), it might cause damage to the plastic parts or start a fire.

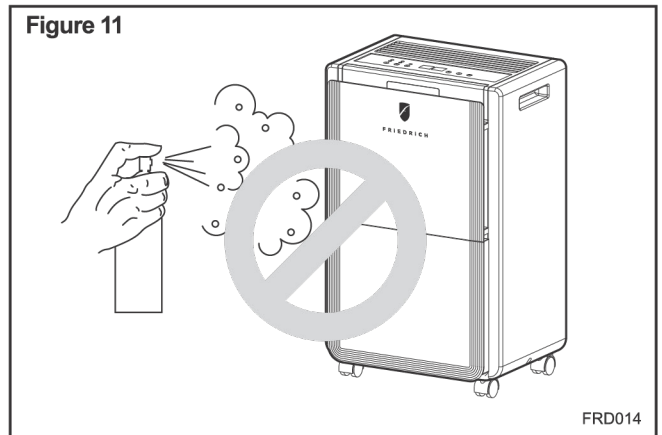

Do not place the unit on an uneven surface (See Figure 12), to avoid shaking, noise and leakage of water.

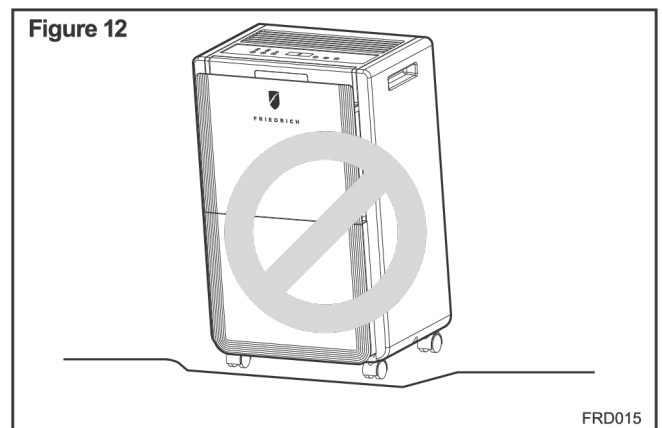

Do always keep the unit 8 in. away from the wall (See Figure 13) to dissipate the heat properly.

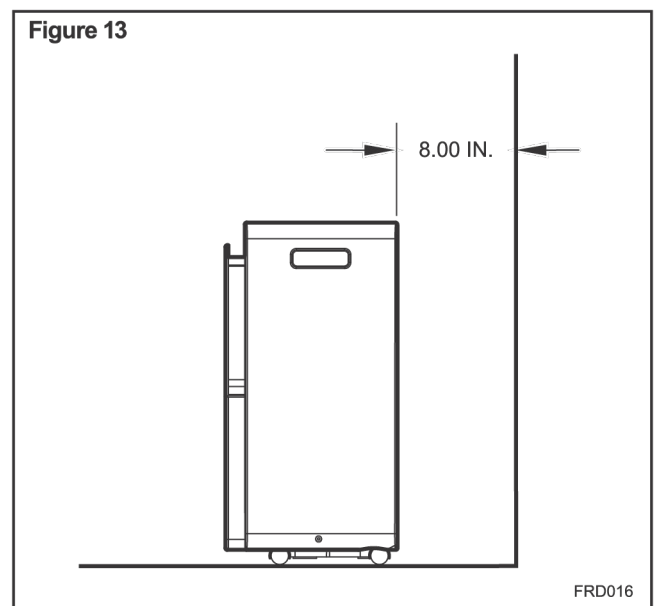

Do not put any foreign objects into the unit, it is dangerous and will result in damage to the unit (See Figure 14).

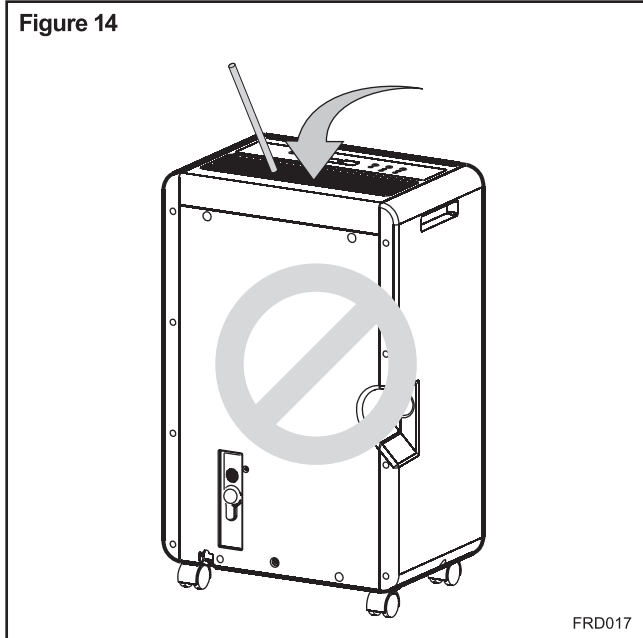

Do close all open windows to reach the maximum possible efficiency of dehumidifier removing moisture (See Figure 15).

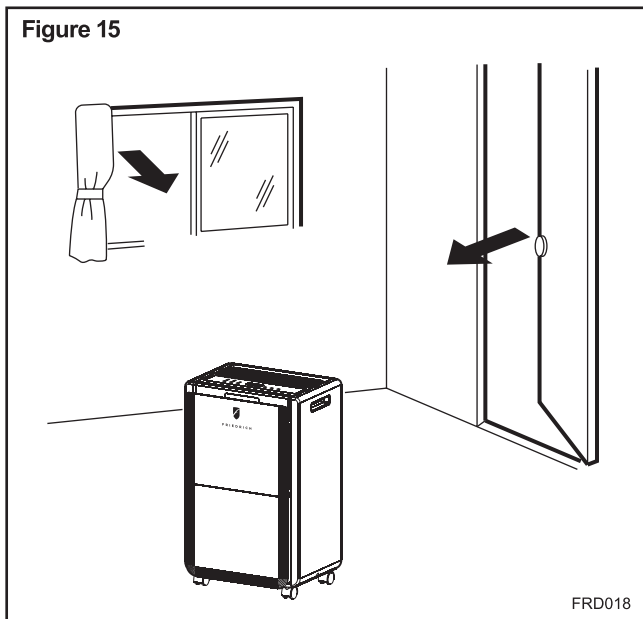

When moving or putting unit in storage, do not place the unit on its side or upside down and avoid violent shaking (See Figure 16).

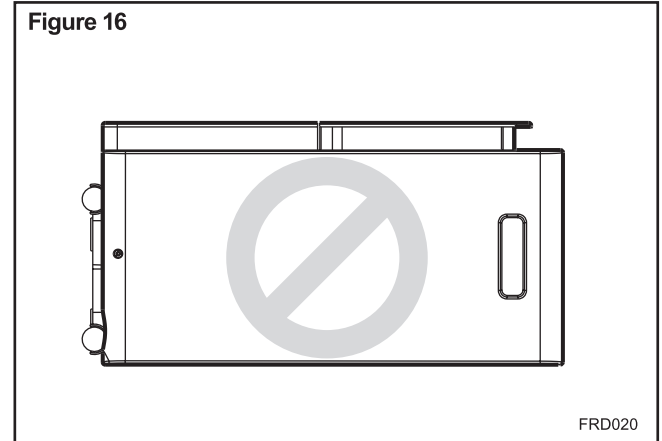

Do ask professional service technicians to service the unit as required (See Figure 17).

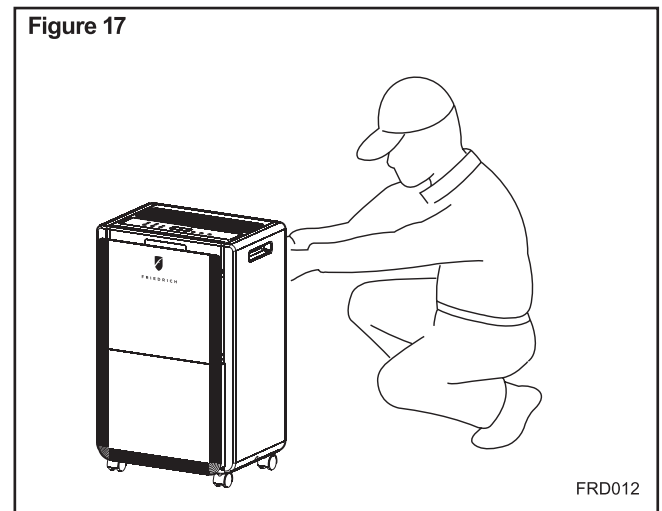

# CONTINUOUS DRAINAGE

To save having to periodically empty the drain bucket, this unit can be configured for continuous drainage. You can use the supplied drain hose to connect to the continuous drainage connector (See Figure 18).

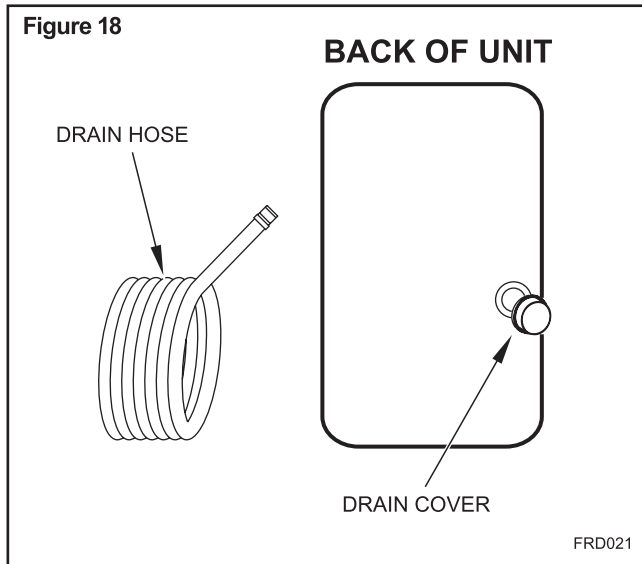

Unscrew and remove the drain cover at the rear of the unit (See Figure 19). Remove the soft rubber stopper. Put it into the drain bucket for safe keeping (See Figure 19).

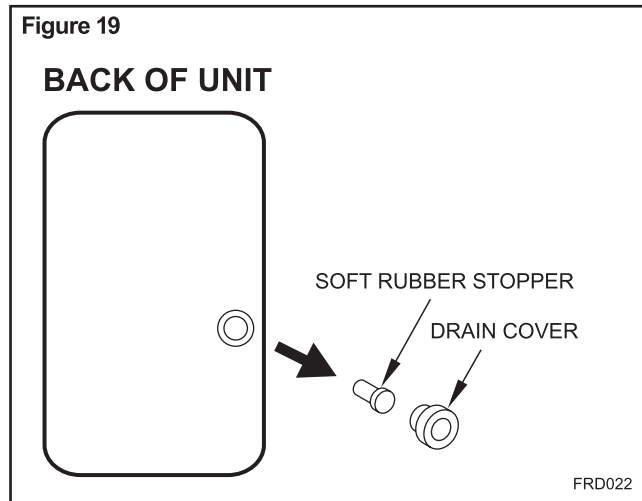

Insert the drain hose through the hole of the drain cover. Then connect the drain hose to the drain port (See Figure 20).

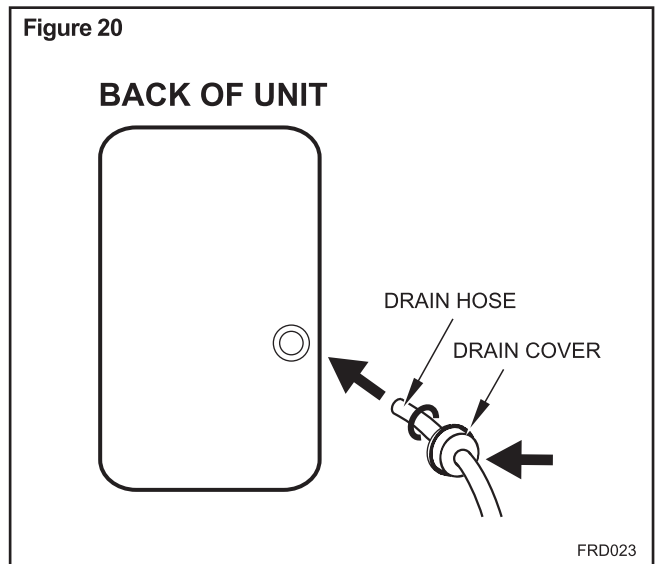

Tighten the drain cover in clockwise direction onto the rear of the unit (See Figure 21).

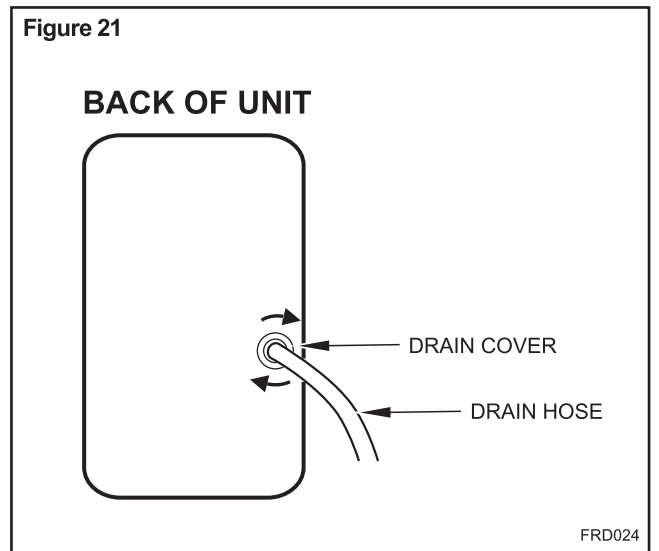

Place the bucket in its original location (See Figure 22).

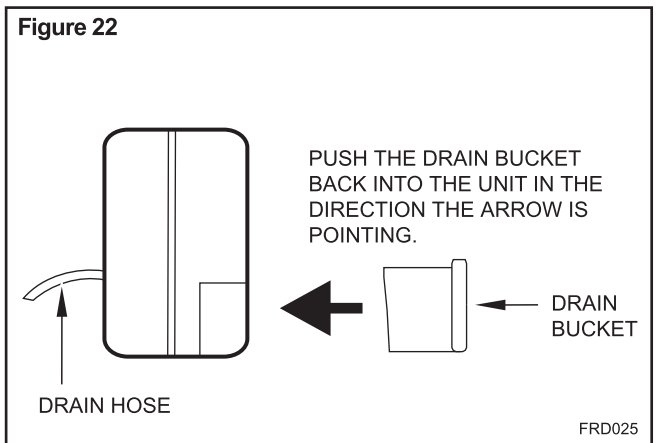



## Continuous Drain Hose Routing

When using the function of continuous drainage, the drain hose must be placed horizontally below the drainage hole (See Figure 23).

You must avoid uneven ground and folding the hose (See Figure 23).

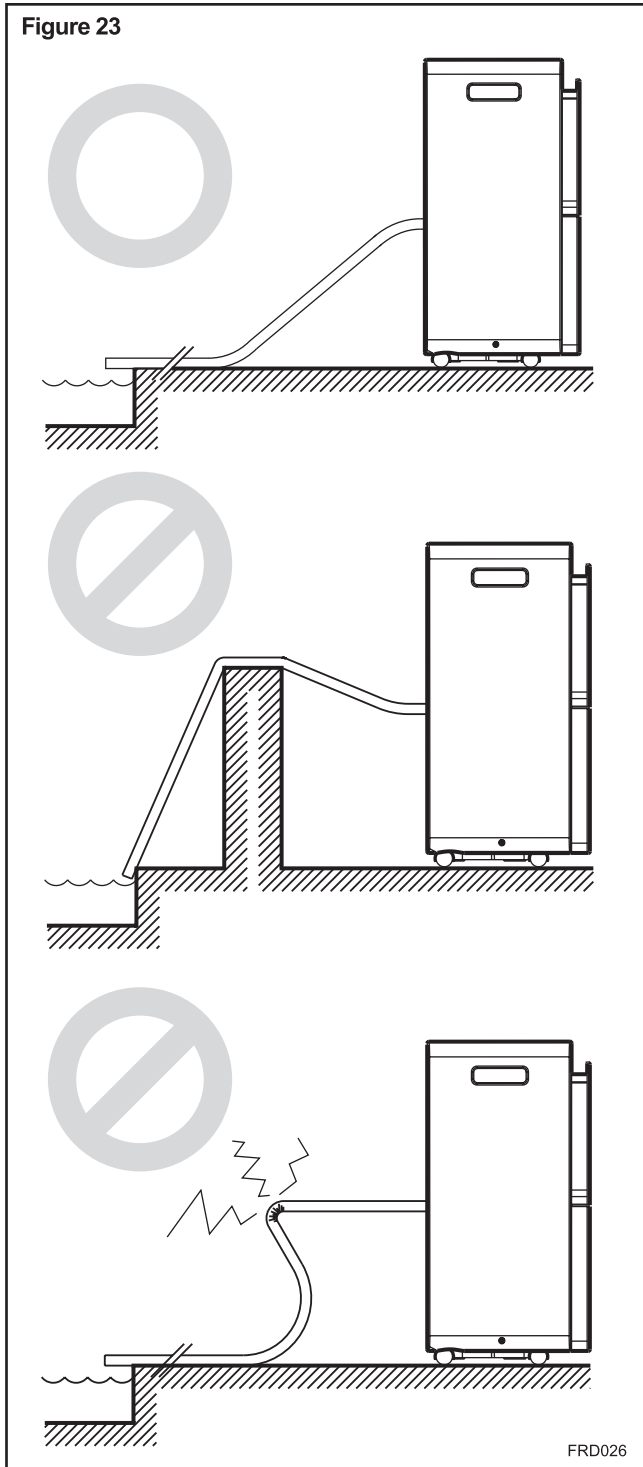

## Continuous Drainage using Built-In Pump

### Installation:

- STEP 1.** Connect the supplied water hose to the drainage key.
- STEP 2.** Connect the drainage key and water hose (1) to the drain pump outlet (2) on the rear panel.
- STEP 3.** Lead the other end to a suitable location for drainage, like a drain or sink and insert the plug into the water drain.

The maximum distance and the rise may be 15 ft from the unit. Exceeding this distance may damage the unit or cause leaks. When the unit's drain bucket capacity reaches a certain water level, it will drain automatically (See Figure 24).

### Dismantle:

Press the drain release button (3) on the unit rear panel. The automatic drainage key will pull out (See Figure 24).

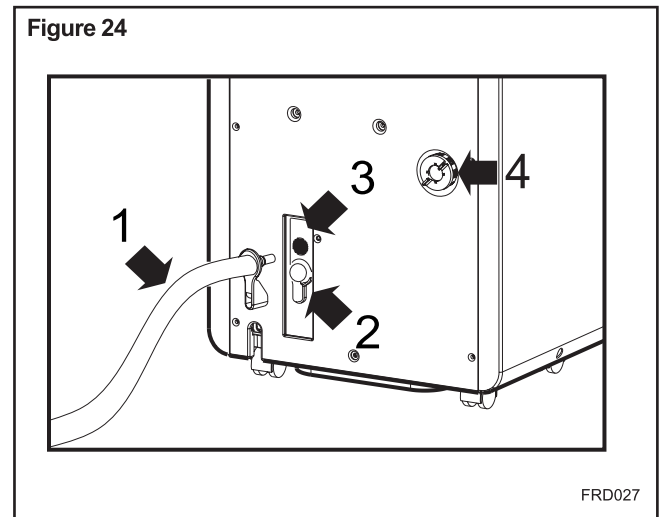

## NOTICE

The rubber drain plug must be inserted in the continuous drainage outlet (4) for built-in pump feature to work. Removing the rubber drain plug will cause the condensation to exit through the continuous drainage outlet instead of the drain pump outlet.

# MAINTENANCE

## ⚠ WARNING



### Electrical Shock Hazard

Make sure your electrical receptacle has the same configuration as your dehumidifier's plug. If different, consult a Licensed Electrician.

Do not use plug adapters.  
Do not use an extension cord.  
Do not remove ground prong.

Always plug into a grounded 3 prong outlet.  
Failure to follow these instructions can result in death, fire, or electrical shock.

For safety reasons, make sure the unit is unplugged before servicing or cleaning.

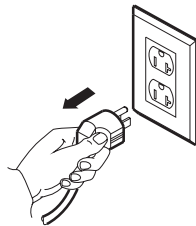

### Cleaning the shell

- STEP 1. Wipe the shell with a clean, soft cloth.
- STEP 2. If the unit is very dirty, use mild detergent then wipe off the detergent with half dried cloth.

## ⚠ WARNING

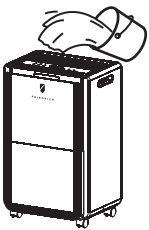

### Water Hazard

Do not wash the unit with a hose or immerse it in water. This may cause leakage of electricity or a shock hazard.

### Cleaning the air filter

The purpose of the air filter is to filter dust and other materials from the air. If the filter is blocked by dust the electricity usage will be greater than normal. For optimal moisture removal and efficiency, clean the filter every two weeks.

## Cleaning Steps

- STEP 1. Pull the air filter out gently (See Figure 25).

Figure 25

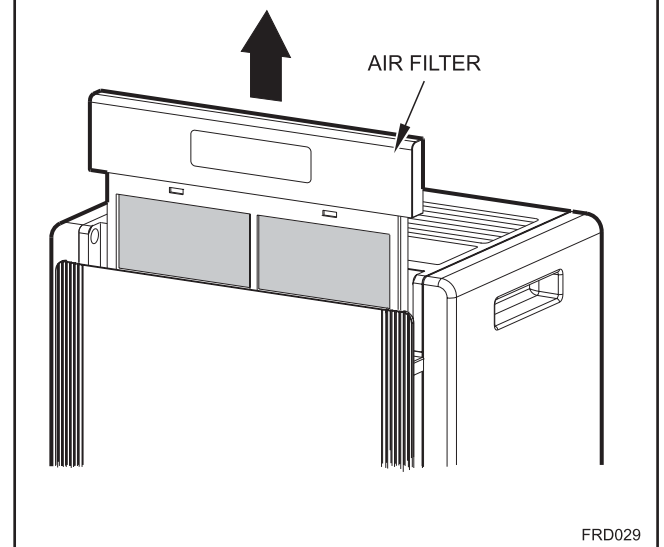

- STEP 2. Clean the air filter with a vacuum cleaner or wash it with clean water and dry with a dry cloth (See Figure 26).

Figure 26

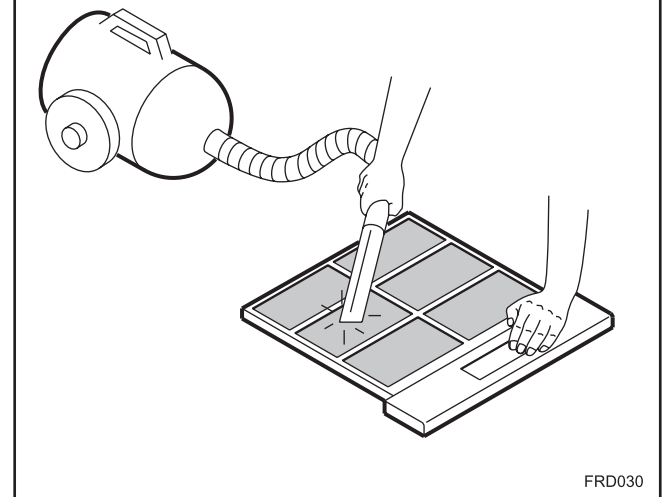

- STEP 3. Put the clean air filter back in place and continue to operate the dehumidifier.

---

## IN CASE OF EMERGENCY

If a problem occurs, unplug the unit and contact a qualified servicing center immediately. Do not disassemble the unit yourself.

### **NOTICE**

If the power cord on this unit is damaged it must be replaced by the manufacturer, its service agent or qualified service technician in order to avoid a hazard.

### **NOTICE**

This appliance is not intended for use by children or other persons without assistance or supervision if their physical, sensory or mental capabilities prevent them from using it safely. Children should be supervised to ensure that they do not play with the appliance.

### **NOTICE**

The appliance shall be installed in accordance with national wiring regulations.

### **NOTICE**

Wiring diagram affixed inside the rear panel.

## TECHNICAL SPECIFICATIONS

Operating temperature / Relative humidity:  
41°F - 89.6°F ( 5-32°C ) / 30%-90%RH



# FRIEDRICH

Friedrich Air Conditioning Company  
10001 Reunion Place, Suite 500  
San Antonio, TX 78216  
800.541.6645  
[www.friedrich.com](http://www.friedrich.com)

## PORTABLE AIR CONDITIONERS & DEHUMIDIFIERS LIMITED WARRANTY

**SAVE THIS CERTIFICATE.** It gives you specific rights. You may also have other rights which may vary from state to state and province to province.

In the event that your Friedrich equipment needs servicing, please contact your nearest authorized service center. If you do not know the nearest service center, ask the company that installed your unit or contact Friedrich (see address and telephone number above). To obtain service and/or warranty parts replacement, you must notify an authorized FRIEDRICH Air Conditioning Co. service center, distributor, dealer, or contractor of any defect within the applicable warranty period.

**When requesting service: the model, serial number, and proof of purchase of your equipment are required and must be readily available.**

**LIMITED WARRANTY – ALL PARTS & LABOR. FIRST YEAR (12 months).** This warranty shall commence on the day of purchase. Any part that is found to be defective in factory-supplied material or workmanship will be replaced or exchanged at the discretion of Friedrich provided the equipment is delivered to a authorized service center.

**These warranties apply only while the unit remains at the original site and only to units installed inside the continental United States, Alaska, Hawaii, Puerto Rico, Mexico and Canada. The warranty applies only if the unit is installed and operated in accordance with the printed instructions and in compliance with applicable local installation and building codes and good trade practices to the end-user purchaser. For international warranty information, contact the Friedrich Air Conditioning Company - International Division. This warranty is not applicable to units on which the model and serial numbers have been removed.**

Any defective unit or part to be replaced must be made available to FRIEDRICH in exchange for the replacement part. Replacement units and/or replacement parts can be new or re-manufactured. Replacement parts shall be warranted for any unused portion of the original unit's warranty.

**APPLICABILITY AND LIMITATIONS** - Friedrich will not be responsible for and the user will pay for:

1. Service calls to: A) Instruct on unit operation. B) Replace batteries, house fuses, or correct house wiring. C) Clean or replace air filters. D) Remove the unit from its installed location when not accessible for service required. E) Correct improper installations.
2. Parts provided by anyone other than an authorized servicer.
3. Damage caused by: A) Accident, abuse, negligence, misuse, riot, fire, flood or acts of God. B) Operating the unit where there is a corrosive atmosphere containing chlorine, fluorine, or any damaging chemicals (other than in a normal residential environment). C) Unauthorized alteration or repair of the unit, which in turn affects its stability or performance. D) Failing to provide proper maintenance and service. E) Using an incorrect power source. F) Faulty installation or application of the unit. G) Operation of the unit during construction.
4. Cost to diagnose the system, removal of the system, freight charges, re-installation charges associated with the repair, or transportation to and from service agency
5. Any additional labor cost for removing inaccessible units

**Friedrich shall not be liable for any incidental, consequential, or special damages or expenses in connection with any use or failure of this unit. Friedrich has not made and does not make any representation or warranty of fitness for a particular use or purpose and there is no implied condition of fitness for a particular use or purpose. Friedrich makes no expressed warranties except as stated in this certification. Friedrich does not authorize any changes to this certificate or to create for Friedrich any other obligation or liability in connection with this unit. Any implied warranties shall last for one year after the original purchase date.** Some states and provinces do not allow limitations on how long an implied warranty or condition lasts, so the above limitation or exclusions may not apply to you. The provisions of this warranty are in addition to and not a modification of or subtraction from the statutory warranties and other rights and remedies provided by law. The most up to date warranty certificates can be found on our website at [www.friedrich.com](http://www.friedrich.com).

**Performance of Friedrich's Warranty obligation is limited to one of the following methods:**

1. A refund to the customer for the prorated value of the unit based upon the remaining warranty period of the unit as calculated by Friedrich Air Conditioning.
2. Providing a replacement unit of equal or lesser value. The replacement unit will adopt the original unit's remaining warranty and shall be covered for the remaining duration as specified above.

Registration is strongly suggested. As described, the Limited Term Warranty coverage is available to owners who have not registered. To register, please visit [www.friedrich.com](http://www.friedrich.com) and select "Product Registration" under our consumer menu selection. California, Florida, and Quebec, Canada residents are not required to register to receive full warranty coverage. Original proof of purchase is required to submit a warranty claim.

**The method of fulfillment of the warranty obligation is at the sole discretion of Friedrich Air Conditioning. In case of any questions regarding the provisions of this warranty, the English version will govern.**



**F R I E D R I C H**

Friedrich Air Conditioning Co.  
10001 Reunion Place • Suite 500 • San Antonio, TX • 78216  
(800) 541-6645  
[www.friedrich.com](http://www.friedrich.com)

Printed in the U.S.A.

97991000\_01